

REINFORCED CONCRETE SLAB H=300mm,
 REBAR TW10 #150 UPPER SURFACE + BOTTOM SURFACE
 (SILOS 8 FLOORS AND LESS, REINFORCED CONCRETE SLAB H=250mm)
 REBAR TW10#150 UPPER SURFACE, -BOTTOM SURFACE)
 FROST INSULATION (IF NECESSARY)
 MOISTURE BARRIER (FLAT BOTTOM SILOS)
 REBAR TW10 #150 UPPER SURFACE + BOTTOM SURFACE
 (SILOS 9 FLOORS AND LESS, REINFORCED CONCRETE SLAB H=250mm)
 REBAR TW10#150 UPPER SURFACE, -BOTTOM SURFACE)
 FROST INSULATION (IF NECESSARY)
 MOISTURE BARRIER (FLAT BOTTOM SILOS)
 REBAR TW10 #150 UPPER SURFACE + BOTTOM SURFACE
 (SILOS 8 FLOORS AND LESS, REINFORCED CONCRETE SLAB H=250mm)
 REBAR TW10#150 UPPER SURFACE, -BOTTOM SURFACE)
 FROST INSULATION (IF NECESSARY)
 MOISTURE BARRIER (FLAT BOTTOM SILOS)

THE SILO IS ESTABLISHED ON A REINFORCED FOUNDATION SLAB, AT LEAST 300mm THICK, WELL-COMPACTED CRUSHED STONE. THE ALLOWABLE BOTTOM PRESSURE USED IN DESIGN IS 100 kN/m².
 THE FOUNDATION IS DRAINED AND THE WATER IS DIRECTED TO THE GROUNDWATER WELL. "DOUBLE-PULL" IS USED AS A DRAINAGE PIPE 117/110, WITH A SLOPE OF 1% AND TP315 DRAINS IN THE CORNERS. THE TOP SURFACE OF THE DRAINAGE PIPE IS AT LEAST 200mm BELOW THE BOTTOM SURFACE OF THE SLAB. DRAINAGE DITCHES MUST BE FROST PROTECTED IF THEY ARE LESS THAN 500mm BELOW GROUND LEVEL.
 PAYLOAD ACCORDING TO EN1991-1-1
 CONSEQUENCE CLASS: CC2
 IMPLEMENTATION CLASS: 2
 IMPLEMENTATION TOLERANCE CLASS: CAST-IN-PLACE STRUCTURES 2
 DESIGN WORKING LIFE: 50 years
 PERMISSIBLE DIMENSIONAL DEVIATION OF CONCRETE STRUCTURES:
 IMPLEMENTATION CLASS 2 = 10mm
 NOMINAL CONCRETE COVER OF STEEL = MINIMUM VALUE + PERMISSIBLE DIMENSIONAL DEVIATION ACCORDING TO IMPLEMENTATION CLASS
 CONCRETE: SOLE C25-30, XC2 PROTECTIVE CONCRETE 50mm WHEN POURED AGAINST THE GROUND, OTHERWISE 25mm
 STEEL: TW=8S500B, A500HW

SLOPE OF THE SURFACE SOIL AWAY FROM THE BUILDING AT THE DISTANCE OF 3 METERS 1:20 !!!!!

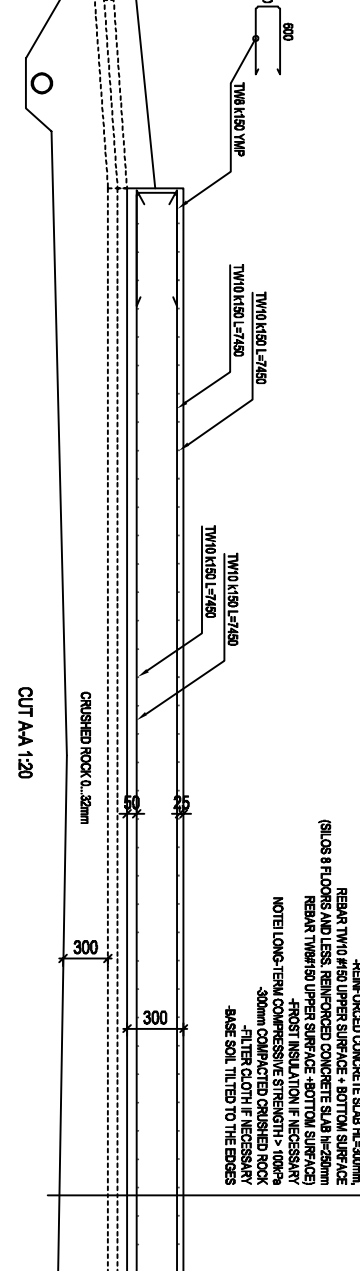

CRUSHED ROCK 0.32mm
 CUT AA 1:20

MOISTURE BARRIER (FLAT BOTTOM SILOS)
 REBAR TW10 #150 UPPER SURFACE + BOTTOM SURFACE
 (SILOS 8 FLOORS AND LESS, REINFORCED CONCRETE SLAB H=250mm)
 REBAR TW10#150 UPPER SURFACE, -BOTTOM SURFACE)
 FROST INSULATION (IF NECESSARY)
 MOISTURE BARRIER (FLAT BOTTOM SILOS)
 REBAR TW10 #150 UPPER SURFACE + BOTTOM SURFACE
 (SILOS 9 FLOORS AND LESS, REINFORCED CONCRETE SLAB H=250mm)
 REBAR TW10#150 UPPER SURFACE, -BOTTOM SURFACE)
 FROST INSULATION (IF NECESSARY)
 MOISTURE BARRIER (FLAT BOTTOM SILOS)

KOKO	KORTITELLYÄ	TOIMITUS	MIENNYSLUOVITUKSET	AKOISSA
MAKUNNANTUNNEPIE LINDSKÄMMENLIS			PERUSTUSRAKENTAMINEN RAKENNEMISEN TUOTO	1:50
MEYU OY			PERUSTUSRAKENTAMINEN PERUSTUSRAKENTAMINEN	1:20
VILJAINLII 72m, TASAPOUJUA JA SISÄKÄYTTÖSILLO				
SUUNNITTELUK:			SUUNNITTELUK	
Ri (AMK) Ossi Valkama			RAK	
			DATE: 28.12.2024	
			YHTIÖ: Ossi Valkama Ri (AMK) 050 3796899	